

# SignWave Receiver

SW3A-2208-EU

Silent Alert SignWave Explained part I of III

Published March, 2019

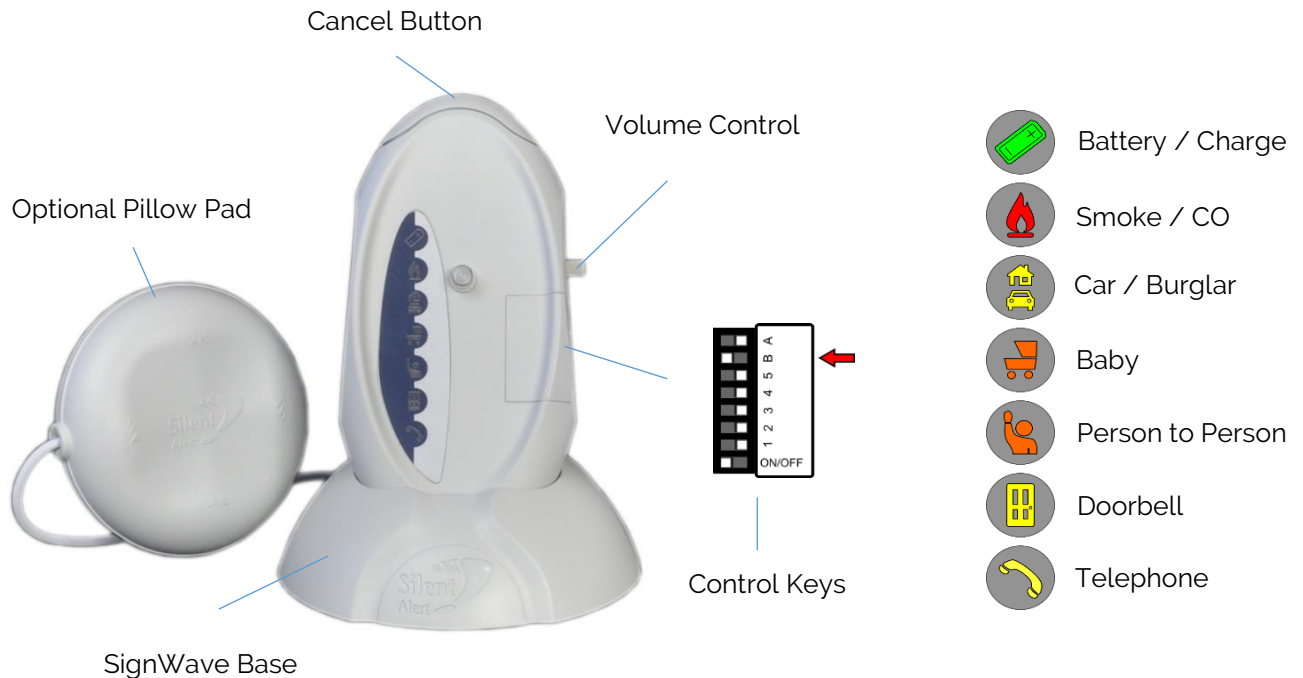

The SignWave can be used to alert the user of a number of events around the home 24 hours a day.

When a signal is received the SignWave makes a noise to simulate the event, flashes a high intensity light and illuminates a symbol on the display. The unit includes a volume control and large cancel button.

The portable SignWave is located on its base at night to recharge. If a signal is received at night the SignWave activates in the usual way and activates an optional pillow pad to wake the user.

## Handy Tip – Flat Battery Recovery

If the SignWave has been left switched ON and allowed to go flat for an extended period of time it can prove difficult to recharge the batteries. The best solution is to place the SignWave on its base (ensuring the mains adaptor is plugged in and switched on) switch the SignWave OFF using the small ON/OFF key and leave for two hours. Switch the SignWave back ON again whilst it is still on the base and charge for a further 24 hours.

## Handy Tip – When a Pillow Pad is not fitted

If a pillow pad is not fitted, move Key B to the ON position, this will stop the battery symbol from flashing orange when the SignWave is on its base.